

We offer an impressive line of enclosures in four different constructions: polyester, polycarbonate, die-cast aluminum and carbon steel. We also offer custom enclosure stations that can be configured and assembled to meet your particular needs.

ENCLOSURES

Polyester 290

Polycarbonate 292

Die Cast Aluminum 296

Conduit Hubs 298



NOTE: The scope (range, description, price, specifications, dimensions, etc.) of the product featured in this section is subject to change without notice. Refer to www.c3controls.com for product updates.

Conformity to Standards:

UL 50
CSA C22.2 No. 94
IEC 60529

Certifications:

UL Listed
CSA Certified



Visit www.c3controls.com to download product certifications.



NOTE: Design subject to change without notice.
Consult factory for current price and dimensions.

DISCOUNT
SCHEDULE **A**

**STANDARD
ENCLOSURE
STATIONS FEATURED
ON THIS PAGE ARE
AVAILABLE FOR
GUARANTEED
SAME-DAY
SHIPPING!**

POLYESTER ENCLOSURES

CONSTRUCTION

- Available for 30mm and 22mm pilot devices
- Solid fiberglass reinforced polyester construction, lightweight with high impact resistance
- Non-conductive double insulated material
- Memory retaining continuous polyurethane gasket that provides a complete watertight, dust tight environmental seal
- Recessed captive 300 Series stainless steel cover screws
- Designed for general electrical and electronic applications and any application that has an associated environmental concern
- Soft edge design reduces dust and other particle corrosion
- Watertight, submersible, non corrosive, environmental design
- UV and chemical resistant
- 30mm Enclosures feature notched keyholes. Available for 22mm as a special order only (not available for guaranteed same day shipping).
- Standard color: Glacier Grey

RATINGS / APPROVALS

- Type 1, 3, 4X, 6P and 12
- Application Temperature Range: -40 to +250° F (-40 to +120° C)
- Flammability Rating: UL94-5V, Self-extinguishing, non-flame propagating

30MM POLYESTER STANDARD ENCLOSURES

CODE	# OF UNITS	CONTACT	OPERATOR	CAP TYPE/COLOR	CLAMP RING	LEGEND/COLOR	PRICE
CS1	1	—	—	—	—	—	\$ 54.00
CS2	2	—	—	—	—	—	\$ 56.00
CS3	3	—	—	—	—	—	\$ 60.00
CS4	4	—	—	—	—	—	\$ 70.00
ECC001	1	NC	Pushbutton/ Maintained	Mushroom/ Red	Polyester	Emergency Stop/ Yellow	\$100.50
ECC002	2	NO	Pushbutton/ Momentary	Flush/Green	Polyester	Start/Black	\$ 97.60
		NC		Extended/Red		Stop/Black	

22MM NEMA AND IEC POLYESTER STANDARD ENCLOSURES

CODE	# OF UNITS	CONTACT	OPERATOR	CAP TYPE/COLOR	CLAMP RING	LEGEND/COLOR	PRICE
22CS1	1	—	—	—	—	—	\$ 54.00
22CS2	2	—	—	—	—	—	\$ 56.00
22CS3	3	—	—	—	—	—	\$ 60.00
22CS4	4	—	—	—	—	—	\$ 70.00
22ECC001	1 (NEMA)	NC	Pushbutton/ Maintained	Mushroom/ Red	Polyester	Emergency Stop/ Yellow	\$ 85.50
22ECC002	2 (NEMA)	NO	Pushbutton/ Momentary	Flush/Green	Polyester	Start/Black	\$ 87.50
		NC		Extended/Red		Stop/Black	
W22ECC001	1 (IEC)	NC	Pushbutton/ Maintained	Mushroom/ Red	Polyester	Emergency Stop/ Yellow	\$ 73.00
W22ECC002	2 (IEC)	NO	Pushbutton/ Momentary	Flush/Green	Polyester	Start/Black	\$ 77.50
		NC		Extended/Red		Stop/Black	

30MM POLYESTER ENCLOSURES

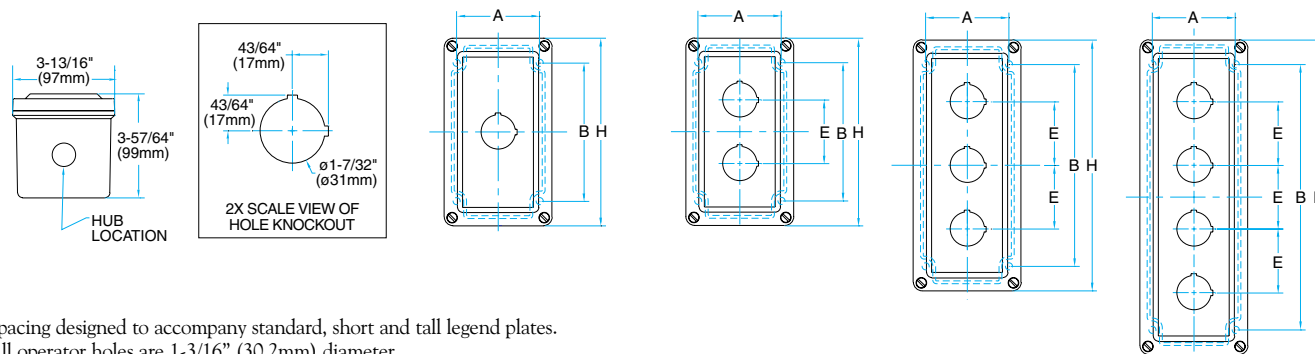

- Spacing designed to accompany standard, short and tall legend plates.
- All operator holes are 1-3/16" (30.2mm) diameter.
- See hub chart below for hub options and drilled hole sizes. All hubs are centered on bottom face of custom enclosures unless otherwise specified.
- Polyester enclosure depth accommodates two 30mm contact blocks deep for a total of four circuits.
- When using a mechanical interlock, enclosure must be ordered with 2" (50.8mm) centers. Please consult factory.
- While our standard enclosures are available for same day shipping, our custom enclosures are not.

30MM POLYESTER HUB SIZE

HUB TYPE	CONDUIT SIZE	DRILL HOLE SIZE
GALVANIZED G50	1/2" (12.7mm)	7/8" (22.5mm)
GALVANIZED G75	3/4" (19.1mm)	1-1/16" (57.2mm)
GALVANIZED G10	1" (25.4mm)	1-5/16" (33.3mm)
ALUMINUM A50	1/2" (12.7mm)	7/8" (22.5mm)
ALUMINUM A75	3/4" (19.1mm)	1-1/16" (57.2mm)
ALUMINUM A10	1" (25.4mm)	1-5/16" (33.3mm)
PVC (NO THREAD) P50	1/2" (12.7mm)	7/8" (22.5mm)
PVC (NO THREAD) P75	3/4" (19.1mm)	1-1/16" (57.2mm)
PVC (NO THREAD) P10	1" (25.4mm)	1-5/16" (33.3mm)
PVC (W/THREAD) R75	3/4" (19.1mm)	1-1/16" (57.2mm)

30MM POLYESTER ENCLOSURE SIZES & HOLE LOCATIONS

PART #	H	A	B	E
CS1	6-5/8" (168.4mm)	2-15/16" (74.7mm)	4-7/8" (123.9mm)	—
CS2	6-5/8" (168.4mm)	2-15/16" (74.7mm)	4-7/8" (123.9mm)	2-1/4" (57.2mm)
CS3	8-7/8" (225.55mm)	2-15/16" (74.7mm)	7-1/8" (181.1mm)	2-1/4" (57.2mm)
CS4	11-1/8" (282.4mm)	2-15/16" (74.7mm)	9-3/8" (238.3mm)	2-1/4" (57.2mm)

22MM POLYESTER ENCLOSURES

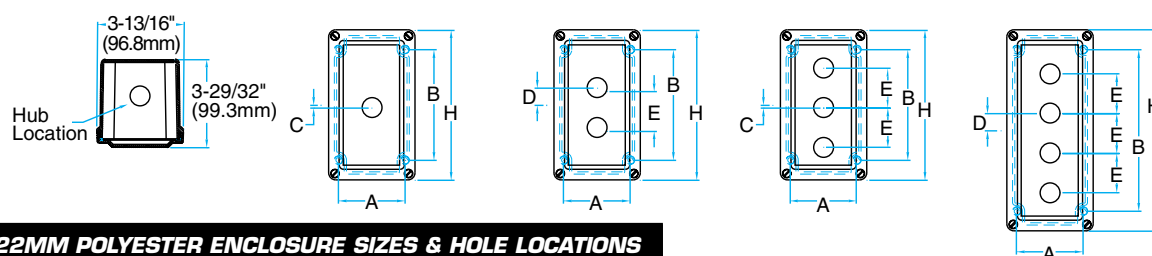

22MM POLYESTER ENCLOSURE SIZES & HOLE LOCATIONS

PART #	H	A	B	C	D	E
22CS1	6-5/8" (168.4mm)	2-15/16" (74.7mm)	4-7/8" (123.9mm)	1/8" (3.2mm)	—	—
22CS2	6-5/8" (168.4mm)	2-15/16" (74.7mm)	4-7/8" (123.9mm)	—	3/4" (19.1mm)	1-3/4" (44.4mm)
22CS3	6-5/8" (168.4mm)	2-15/16" (74.7mm)	7-1/8" (181.1mm)	1/8" (3.2mm)	—	1-3/4" (44.4mm)
22CS4	11-1/8" (282.4mm)	2-15/16" (74.7mm)	9-3/8" (238.3mm)	—	3/4" (19.1mm)	1-3/4" (44.4mm)

22MM POLYESTER HUB SIZE

See 30mm Polyester Hub Size chart above for hub type, conduit size and drill hole size.

- Spacing designed to accompany standard and short legend plates. Consult the factory for tall, jumbo and special legend plate options.
- All operator holes are 7/8" (22.5mm) diameter.
- See hub chart on left for hub options and drilled hole sizes. All hubs are centered on bottom face of custom enclosures unless otherwise specified.
- Polyester enclosure depth accommodates two 22mm IEC contact blocks deep.
- When using a mechanical interlock (22mm NEMA only), enclosure must be ordered with 2" (50.8mm) centers. Please consult factory.
- While our standard enclosures are available for same day shipping, our custom enclosures are not.

POLYCARBONATE ENCLOSURES

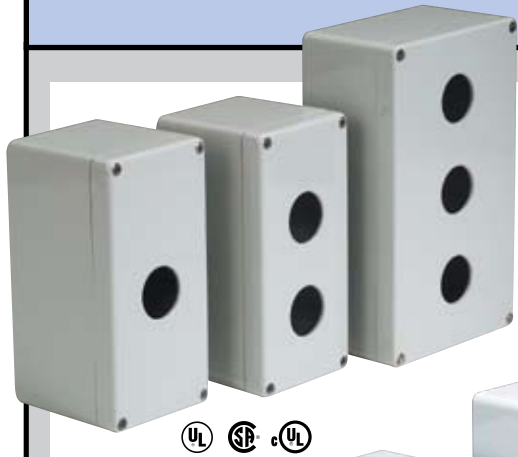

DISCOUNT
SCHEDULE

A

CONSTRUCTION

- Available for 30mm and 22mm pilot devices, and disconnect switches
- Rugged polycarbonate construction, high quality and sealed
- High temperature neoprene gasket
- Highly efficient seal provides ingress protection against dust and moistures
- For greater mechanical protection, the cover gasket is housed in a recess in the lid which mates up with a tongue
 - Standard quarter turn quick release lid fixings
 - Oil and corrosion resistant
 - Standard color: Light Grey

RATINGS / APPROVALS

- Type 1, 4/4X, 12 and IP65
- IP65 protection for watertight and dusttight construction
- Application Temperature Range: -40 to 80°C (-40° to 176°F)



NOTE: Design subject to change without notice. Consult factory for current price and dimensions.

30MM POLYCARBONATE STANDARD ENCLOSURES (NOT RECOMMENDED FOR H-LINE)

CODE	# OF UNITS	LEGEND	PRICE
PC1	1	—	\$38.00
PC2	2	—	\$40.00
PC3	3	—	\$52.00

22MM POLYCARBONATE STANDARD ENCLOSURES

CODE	# OF UNITS	LEGEND	PRICE
22PC1	1	—	\$38.00
22PC2	2	—	\$40.00
22PC3	3	—	\$52.00

DISCONNECTS POLYCARBONATE STANDARD ENCLOSURES

CODE	# OF UNITS	LEGEND	PRICE
PCDSEN	Up to 3 Poles	—	\$32.00
PCDSEN45	Up to 5 Poles	—	\$52.00

DISCOUNT
SCHEDULE

A

30MM POLYCARBONATE ENCLOSURES

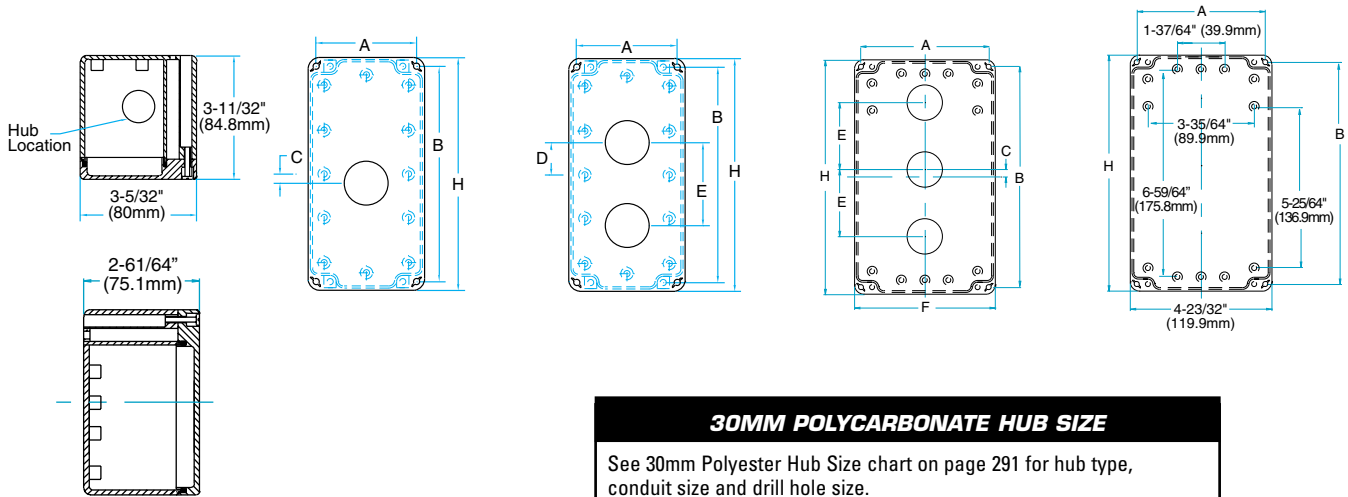

30MM POLYCARBONATE HUB SIZE

See 30mm Polyester Hub Size chart on page 291 for hub type, conduit size and drill hole size.

NOTE: Our PC3 can not be used with a 1" (25.4mm) hub.

- Spacing designed to accompany standard, short and tall legend plates.
- All operator holes are 1-3/16" (30.2mm) diameter.
- See hub chart for hub options and drilled hole sizes. All hubs are centered on bottom face of custom enclosures unless otherwise specified.
- When using a mechanical interlock, enclosure must be ordered with 2" (50.8mm) centers. Please consult factory.
- While our standard enclosures are available for same day shipping, our custom enclosures are not.

30MM POLYCARBONATE ENCLOSURE SIZES & HOLE LOCATIONS

PART #	H	A	B	C	D	E	F
PC1	6-19/64" (160mm)	2-23/32" (69.1mm)	5-53/64" (148.1mm)	1/4" (6.4mm)	—	—	—
PC2	6-19/64" (160mm)	2-23/32" (69.1mm)	5-53/64" (148.1mm)	—	7/8" (22.2mm)	2-1/4" (57.2mm)	—
PC3	7-7/8" (200.2mm)	4-19/64" (109.2mm)	7-13/33" (188.2mm)	1/4" (6.4mm)	—	2-1/4" (57.2mm)	4-47/64" (120.1mm)

22MM POLYCARBONATE ENCLOSURES

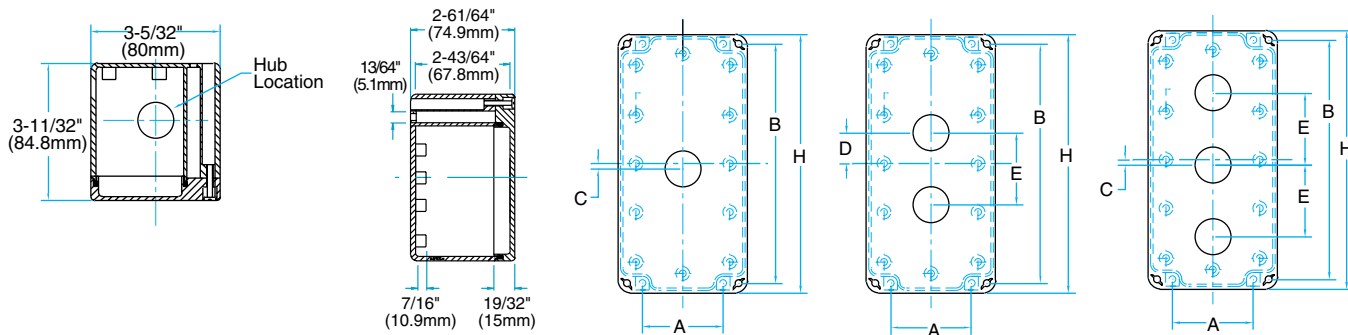

- Spacing designed to accompany standard and short legend plates, consult the factory for tall, jumbo and special legend plate options.
- All operator holes are 7/8" (22.5mm) diameter.
- See hub chart for hub options and drilled hole sizes. All hubs are centered on bottom face of custom enclosures unless otherwise specified.
- Polycarbonate enclosure depth accommodates one 22mm IEC contact block deep when using a 22mm IEC selector switch or two 22mm IEC contact blocks deep with all other 22mm IEC pilot devices. 22mm NEMA pilot devices may use up to three contact blocks deep.
- When using a NEMA mechanical interlock, enclosure must be ordered with 2" (50.8mm) centers. Please consult factory.
- While our standard enclosures are available for same day shipping, our custom enclosures are not.

22MM POLYCARBONATE HUB SIZE

See 22mm Polyester Hub Size chart on page 291 for hub type, conduit size and drill hole size.

22MM POLYCARBONATE ENCLOSURE SIZES & HOLE LOCATIONS

PART #	H	A	B	C	D	E
22PC1	6-19/64" (160mm)	1-31/32" (50mm)	5-53/64" (148.1mm)	1/8" (3.2mm)	—	—
22PC2	6-19/64" (160mm)	1-31/32" (50mm)	5-53/64" (148.1mm)	—	3/4" (19.1mm)	1-3/4" (44.4mm)
22PC3	6-19/64" (160mm)	1-31/32" (50mm)	5-53/64" (148.1mm)	1/8" (3.2mm)	—	1-3/4" (44.4mm)

DISCONNECT POLYCARBONATE ENCLOSURES

PCDSEN

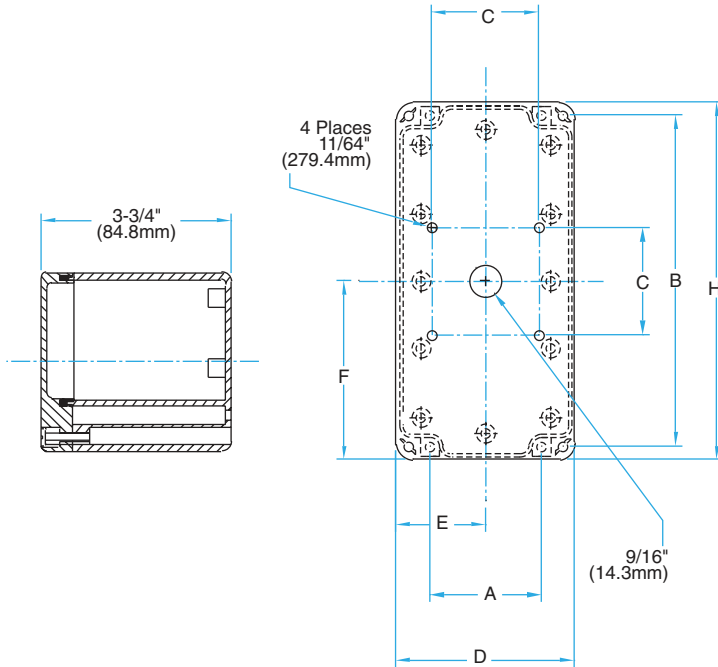

PCDSEN45

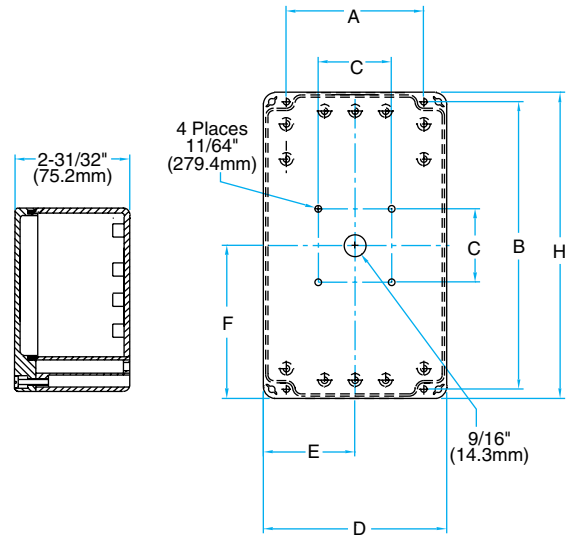

- See hub chart below for hub operators and drilled hole sizes. All hubs are centered on bottom face of custom enclosures unless otherwise specified.
- While our standard enclosures are available for same day shipping, our custom enclosures are not.

DISCONNECT POLYCARBONATE HUB SIZE

See 30mm Polyester Hub Size chart on page 291 for hub type, conduit size and drill hole size.

NOTE: Our PCDSEN45 can not be used with a 1" (25.4mm) hub.

DISCONNECT POLYCARBONATE ENCLOSURE SIZES & HOLE LOCATIONS

PART #	H	A	B	C	D	E	F
PCDSEN	6-19/64" (160mm)	1-31/32" (50mm)	5-53/64" (148.1mm)	1-27/64" (36mm)	3-5/32" (80mm)	1-37/64" (40.1mm)	3-5/32" (80mm)
PCDSEN45	7-7/8" (200.2mm)	3-35/64" (90.2mm)	7-13/32" (187.9mm)	1-27/64" (36mm)	4-47/64" (120.1mm)	2-23/64" (59.9mm)	3-15/16" (100.1mm)



Not Finding What You Need In Our Standard Enclosure Offerings?

c3controls provides Enclosure Stations that can be configured and assembled to meet your particular needs in just about any size or material.

We offer an impressive line of enclosures in four different constructions: Polyester, Polycarbonate, Die-Cast Aluminum and Carbon Steel.

Custom Enclosures, not available for Guaranteed Same-Day Shipping. Please consult factory for price and availability.



For the control freak.

ADVANTAGE PRICING
LIFETIME WARRANTY
GUARANTEED SAME-DAY SHIPPING



c3controls®
EVERYTHING UNDER CONTROL

724.775.7926
WWW.C3CONTROLS.COM

DIE CAST ALUMINUM ENCLOSURES



DISCOUNT
SCHEDULE **A**



NOTE: Design subject to change without notice. Consult factory for current price and dimensions.

CONSTRUCTION

- Available for 30mm and 22mm pilot devices, and disconnect switches
- Die cast aluminum alloy construction
- High temperature neoprene gaskets are oil and petroleum resistant
- Highly efficient seal provides ingress protection against dust and moistures
- For greater mechanical protection, the cover gasket is housed in a recess in the lid which mates up with a tongue
- Oil and corrosion resistant
- Stainless steel captive lid retaining screws
- Standard finish: Smooth powder coat grey

RATINGS / APPROVALS

- 30mm and 22mm Die Cast Enclosures are rated Type 1, 3R, 4, 12, IP66 and IP67
- Disconnect Die Cast Enclosures are rated Type 4/4X, IP66 and IP67
- IP67 protection with a working temperature within -40 to 80°C (-40° to 176°F)

30MM DIE CAST ALUMINUM STANDARD ENCLOSURES (NOT RECOMMENDED FOR H-LINE)

CODE	# OF UNITS	CONTACT	OPERATOR	CAP TYPE/COLOR	CLAMP RING	LEGEND/COLOR	LIST
DC1	1	—	—	—	—	—	\$ 65.00
DC2	2	—	—	—	—	—	\$ 75.00
DC3	3	—	—	—	—	—	\$ 95.00
ECD001	1	NC	Pushbutton/ Maintained	Mushroom/ Red	Polyester	Emergency Stop/ Yellow	\$111.50
ECD002	2	NO	Pushbutton/ Momentary	Flush/Green	Polyester	Start/Black	\$117.00
		NC		Extended/Red		Stop/Black	

22MM NEMA DIE CAST ALUMINUM STANDARD ENCLOSURES

CODE	# OF UNITS	CONTACT	OPERATOR	CAP TYPE/COLOR	CLAMP RING	LEGEND/COLOR	LIST
22DC1	1	—	—	—	—	—	\$ 65.00
22DC2	2	—	—	—	—	—	\$ 65.00
22DC3	3	—	—	—	—	—	\$ 75.00
22ECD001	1	NC	Pushbutton/ Maintained	Mushroom/ Red	Polyester	Emergency Stop/ Yellow	\$ 96.50
22ECD002	2	NO	Pushbutton/ Momentary	Flush/Green	Polyester	Start/Black	\$106.50
		NC		Extended/Red		Stop/Black	

DISCONNECTS DIE CAST ALUMINUM STANDARD ENCLOSURES

CODE	# OF UNITS	LEGEND	LIST
DCDSEN45	Up to 5 Poles	—	\$ 90.00

**STANDARD
ENCLOSURE
STATIONS FEATURED
ON THIS PAGE ARE
AVAILABLE FOR
GUARANTEED
SAME-DAY
SHIPPING!**

30MM DIE CAST ALUMINUM ENCLOSURES

- Spacing designed to accompany standard, short and tall legend plates.
- All operator holes are 1-3/16" (30.2mm) diameter.
- See hub chart below for hub options and drilled hole sizes. All hubs are centered on bottom face of custom enclosures unless otherwise specified.
- Die cast enclosure depth accommodates one contact block.
- When using a mechanical interlock, enclosure must be ordered with 2" (50.8mm) centers. Please consult factory.
- While our standard enclosures are available for same day shipping, our custom enclosures are not.

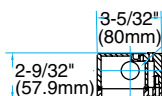

Hub Location

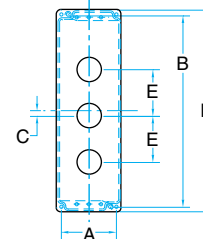
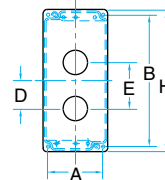
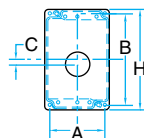

30MM DIE CAST HUB SIZE

HUB TYPE	CONDUIT SIZE	DRILL HOLE SIZE
GALVANIZED G50	1/2" (12.7mm)	7/8" (22.5mm)
ALUMINUM A50	1/2" (12.7mm)	7/8" (22.5mm)
PVC (NO THREAD) P50	1/2" (12.7mm)	7/8" (22.5mm)

30MM DIE CAST ENCLOSURE SIZES & HOLE LOCATIONS

PART #	H	A	B	C	D	E
DC1	4-59/64" (125mm)	2-11/16" (68.1mm)	4-29/64" (113mm)	1/4" (6.35mm)	—	—
DC2	6-7/8" (174.75mm)	2-11/16" (68.1mm)	6-13/32" (162.8mm)	—	1-3/8" (34.9mm)	2-1/4" (57.2mm)
DC3	9-13/16" (249.2mm)	2-11/16" (68.1mm)	9-11/32" (237mm)	1/4" (6.35mm)	—	2-1/4" (57.2mm)

22MM NEMA DIE CAST ALUMINUM ENCLOSURES

- Spacing designed to accompany standard and short legend plates, consult the factory for tall, jumbo and special legend plate options.
- All operator holes are 7/8" (22.5mm) diameter.
- See hub chart below for hub options and drilled hole sizes. All hubs are centered on bottom face of custom enclosures unless otherwise specified.
- 3/4" (19.1mm) and 1" (25.4mm) hubs not available, consult factory for options.
- When using a mechanical interlock, enclosure must be ordered with 2" (50.8mm) centers. Please consult factory.
- While our standard enclosures are available for same day shipping, our custom enclosures are not.

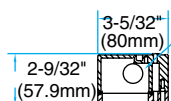

Hub Location

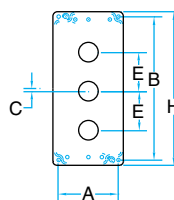
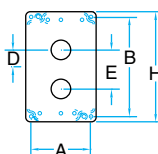
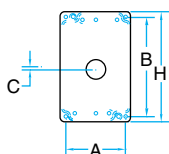

22MM DIE CAST HUB SIZE

HUB TYPE	CONDUIT SIZE	DRILL HOLE SIZE
GALVANIZED G50	1/2" (12.7mm)	7/8" (22.5mm)
ALUMINUM A50	1/2" (12.7mm)	7/8" (22.5mm)
PVC (NO THREAD) P50	1/2" (12.7mm)	7/8" (22.5mm)

22MM DIE CAST ENCLOSURE SIZES & HOLE LOCATIONS

PART #	H	A	B	C	D	E
22DC1	4-59/64" (125mm)	2-11/16" (68.1mm)	4-29/64" (113mm)	1/8" (3.2mm)	—	—
22DC2	4-59/64" (125mm)	2-11/16" (68.1mm)	4-29/64" (113mm)	—	3/4" (19.1mm)	1-3/4" (44.5mm)
22DC3	6-5/8" (168.4mm)	2-11/16" (68.1mm)	6-13/32" (162.8mm)	1/8" (3.2mm)	—	1-3/4" (44.5mm)

VISIT WWW.C3CONTROLS.COM
TO DOWNLOAD CAD DRAWINGS

DISCONNECT DIE CAST ALUMINUM ENCLOSURE

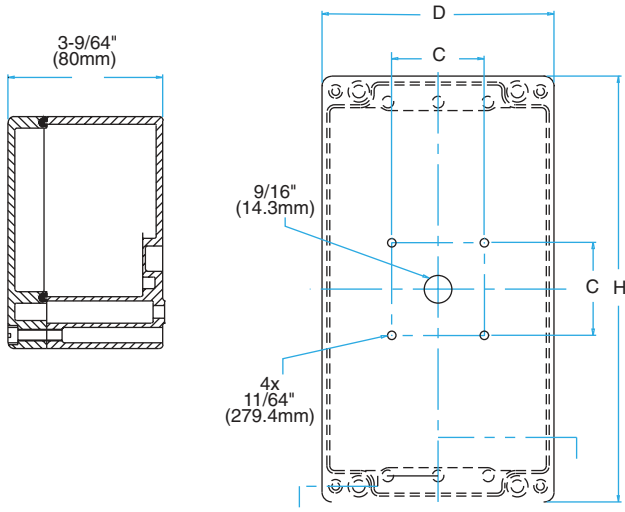

- See hub chart below for hub operators and drilled hole sizes. All hubs are centered on bottom face of custom enclosures unless otherwise specified.
- While our standard enclosures are available for same day shipping, our custom enclosures are not.

DISCONNECT DIE CAST HUB SIZE

HUB TYPE	CONDUIT SIZE	DRILL HOLE SIZE
GALVANIZED G50	1/2" (12.7mm)	7/8" (22.5mm)
GALVANIZED G75	3/4" (19.1mm)	1-1/16" (57.2mm)
ALUMINUM A50	1/2" (12.7mm)	7/8" (22.5mm)
ALUMINUM A75	3/4" (19.1mm)	1-1/16" (57.2mm)
PVC (NO THREAD) P50	1/2" (12.7mm)	7/8" (22.5mm)
PVC (NO THREAD) P75	3/4" (19.1mm)	1-1/16" (57.2mm)
PVC (W/THREAD) R75	3/4" (19.1mm)	1-1/16" (57.2mm)

DISCONNECT DIE CAST ENCLOSURE SIZES & HOLE LOCATIONS

PART #	H	A	B	C	D	E	F
DCDSEN45	8-43/64" (220.2mm)	—	—	1-27/64" (36mm)	4-23/32" (120mm)	—	—

CONDUIT HUBS

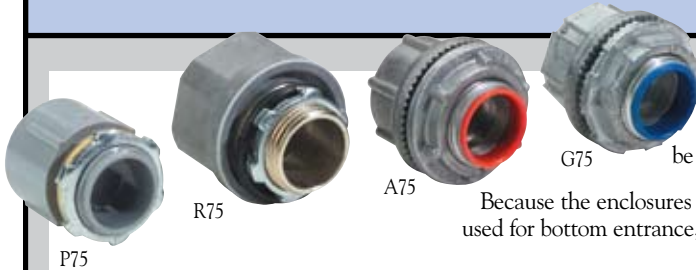

Hubs may be purchased separately, installed, or conduit hole only may be specified. If hub or conduit hole is specified, location must be indicated on order form.

Because the enclosures are symmetrical, a top hub or hole may be field installed with the hub used for bottom entrance, while side mounting may be used for either left or right entry.

CONDUIT HUBS FOR 30MM, 30MM H-LINE, 22MM AND DISCONNECTS

CONDUIT SIZE	PVC (NO THREAD)			PVC (W/THREAD)			ALUMINUM			GALVANIZED			CONDUIT HOLE ONLY	
	CODE	SEP.	INST.	CODE	SEP.	INST.	CODE	SEP.	INST.	CODE	SEP.	INST.	CODE	LIST
1/2"	P50	\$ 2.00	\$ 8.00	—	—	—	A50	\$ 9.50	\$15.50	G50	\$ 9.50	\$15.50	H50	\$ 3.00
3/4"	P75	\$ 3.00	\$ 9.00	R75	\$18.00	\$24.00	A75	\$10.00	\$16.00	G75	\$10.00	\$16.00	H75	\$ 3.00
1"	P10	\$ 4.00	\$10.00	—	—	—	A10	\$10.50	\$16.50	G10	\$10.50	\$16.50	H10	\$ 3.00

DISCOUNT
SCHEDULE

A



Freedom to innovate

It takes a great team and capable partners to produce innovative defluxing systems, ultrasonic stencil cleaners and cleanliness testing systems for printed circuit board (PCB) assemblies.

Aqueous Technologies is leading the way with award winning products and a track record of success unmatched in the industry.

c3controls shares our commitment to excellence by delivering a combination of quality, value, availability and service unlike any other standard industrial control manufacturer.

—Ron Rumrill

Manager of Engineering
Aqueous Technologies

c3controls never compromises and neither should you. Discover the c3controls difference that gets you what you want, when you need it, at a price that will surprise you.

Join the growing list of control freaks that expect more and get it from c3controls.



I'm a control freak.

ADVANTAGE PRICING

LIFETIME WARRANTY

GUARANTEED SAME-DAY SHIPPING



c3controls®
EVERYTHING UNDER CONTROL

724.775.7926

WWW.C3CONTROLS.COM/CONTROLFREAK-AQ